

See Inset A

See Inset B

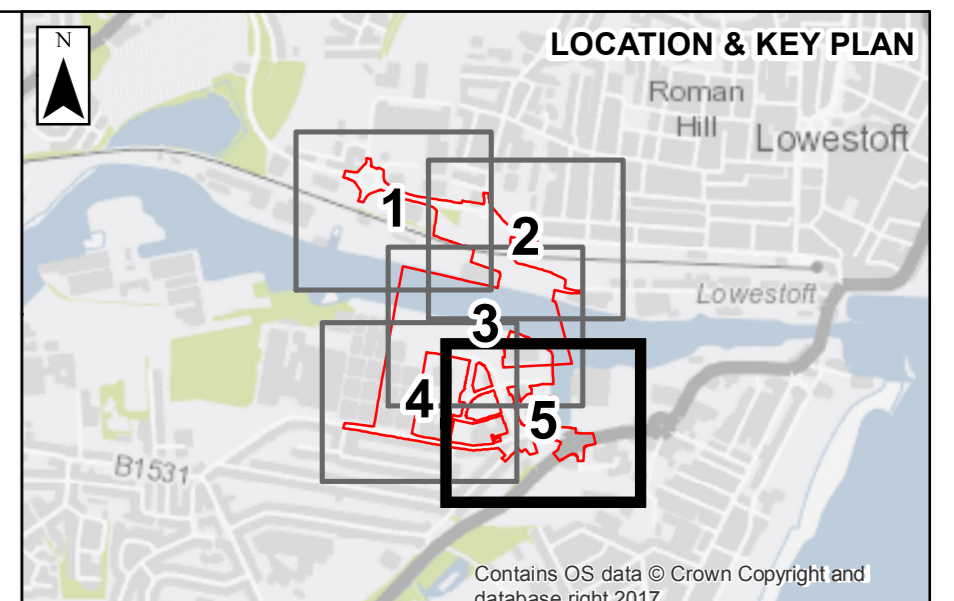
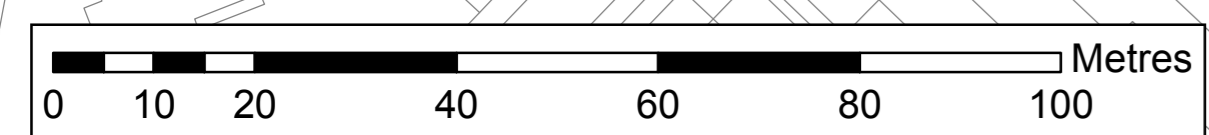
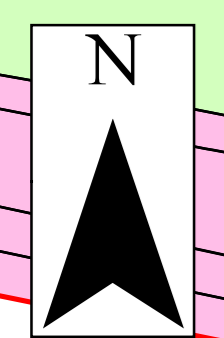
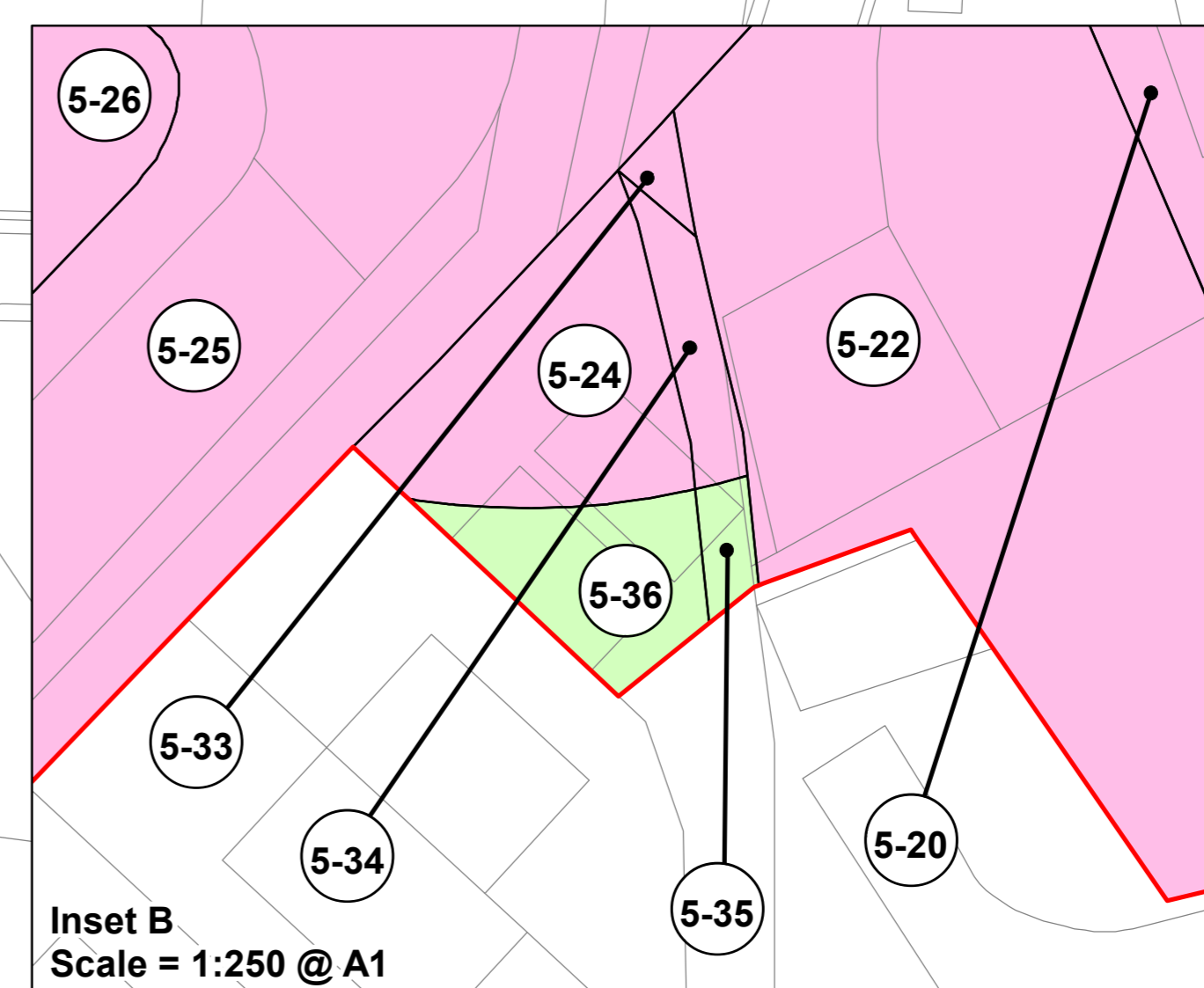

- KEY**
- Order Limits
 - Land Use and Plot Boundary**
 - Permanent acquisition of land
 - Permanent acquisition of airspace and rights over land
 - Permanent acquisition of rights over land
 - Temporary possession of land

- NOTES:**
1. These Land Plans should be read in conjunction with the other plans and documents in the Development Consent Order application, in particular the Book of Reference.
 2. All easements, servitudes and private rights are proposed to be extinguished on land that is to be acquired, unless stated otherwise.
 3. The numbers relate to plot numbers. Please refer to the Book of Reference for more information about these plots, including the approximate area of each plot (in square metres).
 4. Plot numbers include a reference to the relevant sheet of the Land Plans. In this numbering convention, a plot number comprises the sheet number followed by the actual plot number e.g. Plot 2-05 - where "2" is the sheet number (sheet 2) and "05" is the plot number (plot 5 on sheet 2).
 5. The colour of a plot provides an initial indication of the purpose for which the land in a plot is required - please refer to the key.

Mapping reproduced by permission of Ordnance Survey on behalf of HMSO.
 © Crown copyright and database rights 2017. All rights reserved.
 Ordnance Survey licence number 100023395
 Contains OS data © Crown copyright and database rights 2017.

REVISION	DRAWN	CHECKED	APPROVED	DATE
DESCRIPTION				

Suffolk County Council

PROJECT TITLE

Lake Lothing
THIRD CROSSING

DRAWING TITLE

**LAND PLANS
REGULATION 5(2)(i)
SHEET 5 OF 5**

DRAWING STATUS

FOR DCO SUBMISSION

DRAWN	CHECKED	APPROVED	AUTHORISED	SUITABILITY
DE	BOH	SC	JB	S4
SCALE @ A1 SIZE		DATE	REVISION	
1:750		14/06/2018	P00	
DRAWING NUMBER				
Project		Originator	Volume	
1069948-WSP-LSI-LL-DR-GI-0006				
Location	Type	Role	Number	